



awnings
2023

Index



Inflatable awnings

| | |
|----------------------|---|
| Atmosphere 350 | 4 |
| Atmosphere 300 · 400 | 6 |

Privacies

| | |
|--|----|
| Dynamic | 8 |
| Venecia 350 · 400 | 10 |
| Side panel F45 | 11 |
| CS-Activa and CS-Activa XL | 12 |
| Side and front panels for CaravanStore | 14 |

Acrylic awnings

| | |
|-----------------------|----|
| Sands 250 COAL · AZUR | 16 |
| Fjord 300 COAL · AZUR | 16 |

PVA polyester awnings

| | |
|-----------------------|----|
| Stela 250 · 300 · 350 | 18 |
|-----------------------|----|

PVC polyester awnings

| | |
|---------------------|----|
| Fusion 250 · 300 | 20 |
| Galileo 250s · 270s | 22 |
| Sintra 250 | 24 |

Winter awnings

| | |
|-------------------------------|----|
| Alpes 320 · 380 · 420 CLASSIC | 26 |
| Alpes 320 · 380 · 420 AZUR | 28 |
| Puigmal 250 | 30 |

Spring awnings

| | |
|--------------|----|
| Mercury 360 | 32 |
| Jeroboam 360 | 33 |

Sun canopies

| | |
|------------------|----|
| Front sun canopy | 34 |
| Ibiza canopy | 35 |
| Verona canopy | 36 |

Complements

| | |
|-------------|----|
| Annexes | 36 |
| Windscreens | 37 |

Kitchen tents

| | |
|----------|----|
| Inca | 38 |
| Java | 39 |
| Arosa | 39 |
| Victoria | 40 |
| Nepal | 40 |
| Messina | 40 |
| Teide | 40 |



Accessories

| | |
|-------------------------------|----|
| Curtains | 41 |
| Thermal blinds | 41 |
| Lago curtains | 41 |
| Mosquito net side panel | 41 |
| Inner roof (velum) | 42 |
| Plastic matting | 42 |
| UNI storm straps | 42 |
| Wheel cover and tow-bar cover | 42 |
| Premium carpets | 43 |
| Poles | 43 |

Technical data

| | |
|-----------------------------|----|
| Specifications chart | 44 |
| Advices and recommendations | 46 |
| Sizes and weights chart | 46 |

Retailers

47



INDUSTRIA AUXILIAR DE LA CARAVANA

www.inaca.com



@inacacamping

Atmosphere 350





Inflatable awning made with european standards and materials.

It fits perfectly to the guide of the caravan or to the front of canopy from 350 cm. The frame is a combination of air and alloy poles. Light and very multifunctional.

These are the best choice for itinerant use and short stays.

Specifications

 Suitable for caravans and motorhomes

 Air and aluminium poles frame

 Depth 250 cm
Length 340 cm

 Mosquito net on each side panel

 Extra ventilation on each side



Sizes



| Size | Height | Suitable for |
|------|--------------|-----------------------|
| S | 235 a 255 cm | caravan and motorhome |
| M | 256 a 275 cm | motorhome |
| L | 276 a 295 cm | motorhome |
| XL | 296 a 315 cm | motorhome |

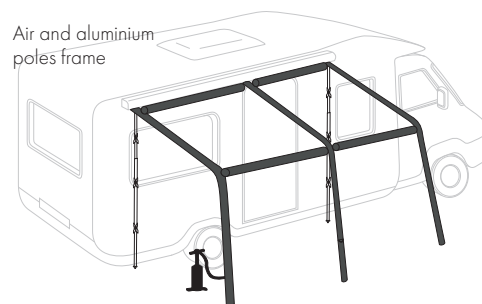

Color scheme



Dark grey RipStop



Light grey RipStop



Curtains included
#7 Whites



Atmosphere

300 · 400

Inflatable awning made with european standards and materials.

It fits perfectly to the guide of the caravan or to the front of canopy from 300 or 400 cm. The frame is a combination of air and alloy poles. Light and very multifunctional.

These are the best choice for itinerant use and short stays.

Specifications



Suitable for caravans and motorhomes



Air and aluminium poles frame



Atmosphere 300
Depth 250 cm
Length 298 cm

Atmosphere 400
Depth 250 cm
Length 388 cm



Mosquito net on each side panel



Extra ventilation on each side



Atmosphere 300



Atmosphere 400

Sizes



300

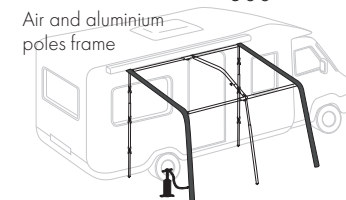

400

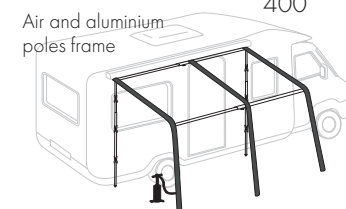

| Size | Height | Suitable for |
|------|-----------------|--------------------------|
| S | 235 a 255 cm | caravan and motorhome |
| M | 256 a 275 cm | motorhome |

Color scheme



Dark grey
RipStop



Light grey
RipStop



Curtains included #7 Whites



Dynamic



Privacy awning to fit canopies. Model available for any length and height. Conceived in a new color combination, it has windows with mosquito nets and doors on the sides as well as an independent front door that can be placed in any position.

The base panel is 300 cm and panels of 50 and 100 cm (with window) are added in relation to the length of the awning.

It is supplied with the original FIAMMA Clip system structure.

Specifications



Suitable for caravans and motorhomes



FIAMMA aluminium frame



Mosquito net on side panels



To fit canopies:
 FIAMMA: F45S, F45L, F45Ti, F45i, F50, F55 and F1
 THULE: Omnistor 5003
 With adapter: 5002, 4900, Tristor 2 and Prostor

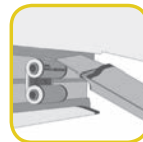
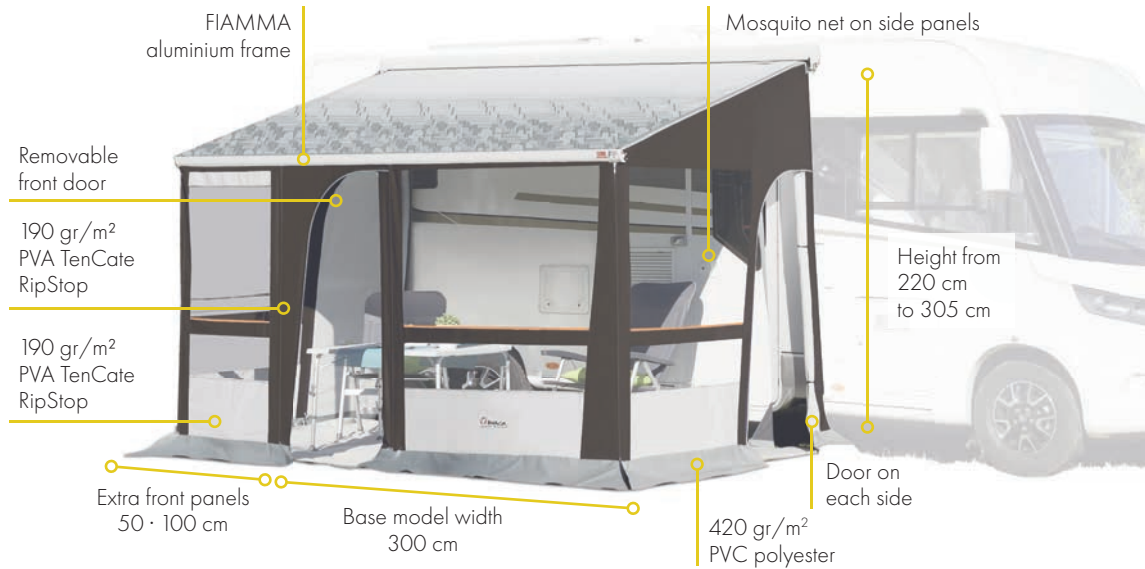

FIAMMA F45S, F45Ti, F45i,
 (98655-897 from 350 to 400)
 FIAMMA F45L, F45TiL, F45iL,
 (98655-898 from 450 to 550)

FIAMMA
 F45S 300 and
 F45Ti 300
 (98655-900)



THULE 5003
 (98655-897)



THULE 5002, 4900 and Tristor2
 (98655-897 + optional accessory
 98655-901)

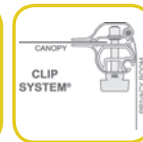
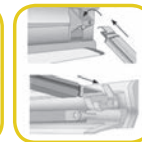
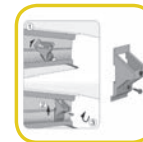

Prostor (98655-898 + 98655-900)



Sizes

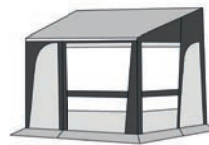

| Size | Height |
|------|--------------|
| S | 220 a 245 cm |
| M | 246 a 270 cm |
| L | 271 a 290 cm |
| XL | 291 a 305 cm |

Optional accessories

- Curtains
- Mudflap for the vehicle
- Rear set with alloy leg poles

Color scheme



Blue RipStop



Light grey RipStop



Dark grey RipStop



Light grey RipStop



Curtains included
 Grey Dynamic
 #1 Grey stars



Curtains included
 Blue Dynamic
 #2 Blue stars



Venecia

350 · 400

Privacy awning to fit canopies. To fit caravans and low motorhomes (height range from 230 to 255 cm).

The side and front panels of this model are connected with a zip, so it can be dismantled in parts, leaving only one of the panels.

The front panel is one piece of 350 or 400 cm.

Specifications



Suitable for caravans and motorhomes



To fit canopies:
FIAMMA: F45
THULE: 5003, 5002, 4900 or Prostor, 350 or 400 cm long. One height only covering a range from 230 to 255 cm.



Height from 230 to 255 cm



Removable by panels



Mosquito net on each side panel

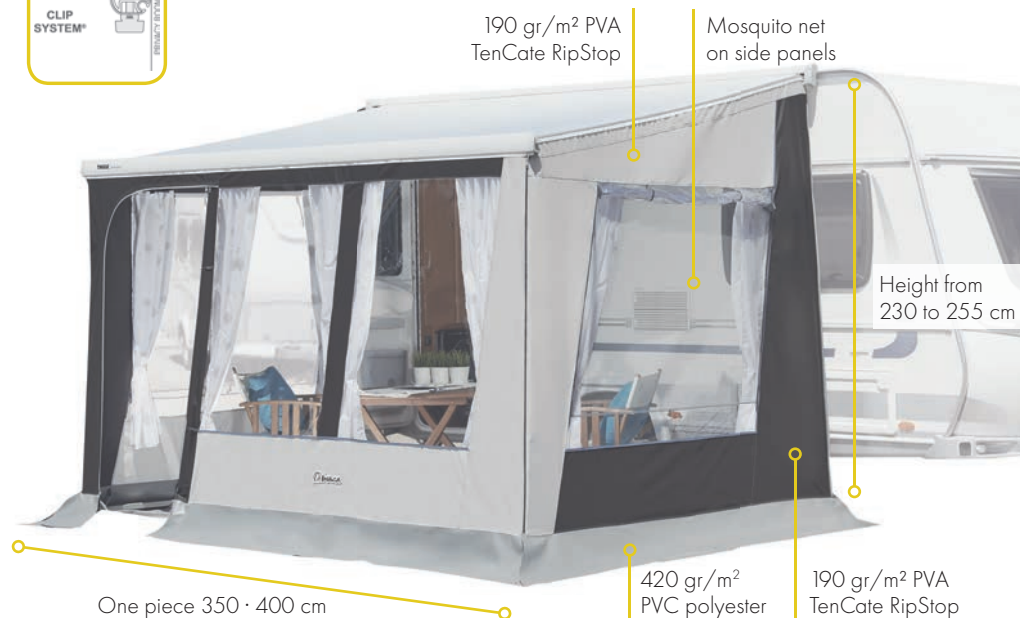
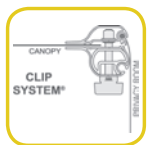

Side panel F45



Sizes

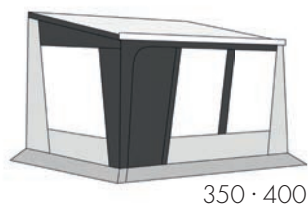

Color scheme



Dark grey RipStop



Light grey RipStop



Curtains included
#7 Whites

Side panel available to fit FIAMMA and Omnistor canopies. Provided with original alloy rafter by FIAMMA.

Adjustable in height from 235 to 270 cm. Right and left side. Optional window cover available.

CS-Activa CS-Activa XL



Privacy to fit FIAMMA CaravanStore and CaravanStore XL.
Manufactured in RipStop polyester.

The front and side panels are linked by zips. The sides are tensioned against the vehicle wall through elastic cord, and are fitted with original FIAMMA frames, either the complete Easy clip or simple alloy rafters.

Optionally, the rear set (foam pads and alloy leg poles) can be installed to achieve optimum fit to the vehicle.

Specifications



To fit FIAMMA CaravanStore and CaravanStore XL



Built in RipStop polyester



| Standard | XL |
|---------------|---------------|
| Depth | Depth |
| 225 cm | 250 cm |
| Length | Length |
| 225 to 440 cm | 280 to 550 cm |



Removable front door with zippers



Mosquito net on side panels

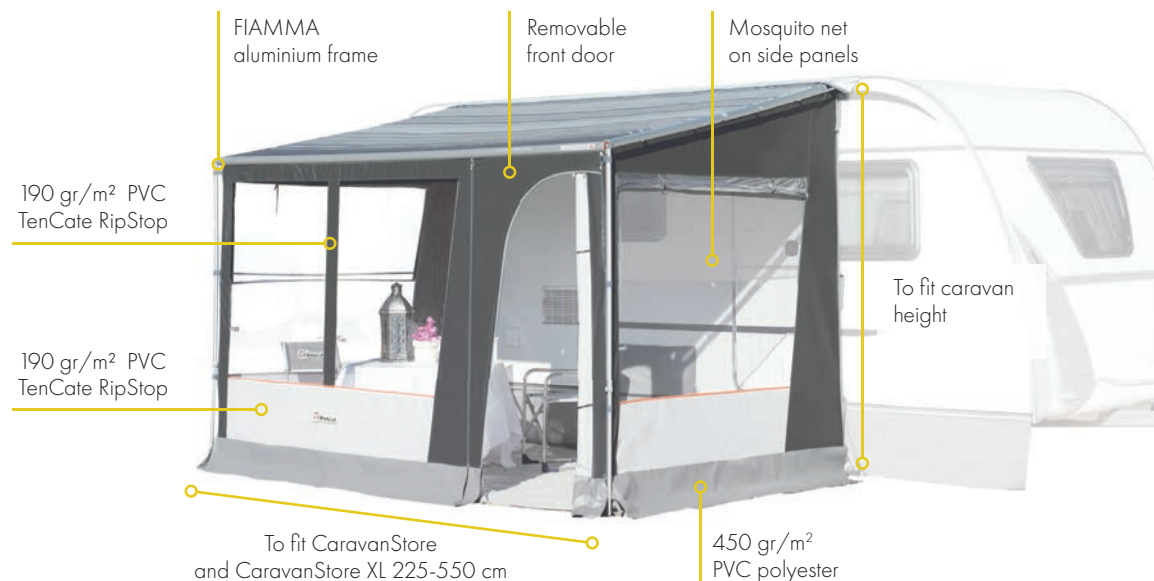

Sizes

Standard and XL



| Standard | XL |
|--------------|--------------|
| 225 cm depth | 250 cm depth |
| Length | |
| 225 cm | - |
| 255 cm | - |
| 280 cm | 280 cm |
| 310 cm | 310 cm |
| 360 cm | 360 cm |
| 410 cm | 410 cm |
| 440 cm | 440 cm |
| - | 500 cm |
| - | 550 cm |

Optional accessories

- Curtains
- Mudflap for the vehicle
- Rear set with foam pads and alloy leg poles to achieve optimum fit to the vehicle

Color scheme

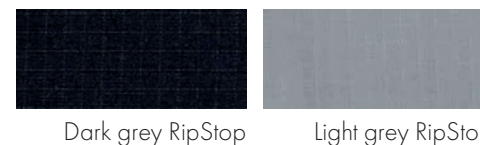



Side and front panels for CaravanStore

The panels are available to be attached to FIAMMA CaravanStore and CaravanStore XL, which is usually installed in a caravan. The optimum height for which it is available is 245 cm, there being a reasonable margin in both directions and the anchors are adjustable in height.

They are made of polyester PVA RipStop, fully breathable, very light and resistant. The combination of colors is unique and universal, blue and grey that fit perfectly with Caravanstore tones. The panels are sold separately providing great flexibility in the combinations.

The sides have a wide window with the option to include curtains. The frame (roof pole) is made of anodized aluminum.

The front is configured for the different Caravanstore and has in all cases a roller door, with zip and one/two windows also with option to fit curtains.

The front and the side are attached to cotton tapes, to the legs of the canopy itself. In this way we gain in lightness and flexibility. Also available in an adaptable version to F35 canopies in all its dimensions, matching all its specifications.

Specifications

 To fit FIAMMA CaravanStore and CaravanStore XL

 Built in RipStop polyester

 To fit caravan height



Sizes

- Front from 225 cm to 550 cm
- Side panels CaravanStore (225 cm) and CaravanStore XL (250 cm)

Optional accessories

- Curtains

Color scheme

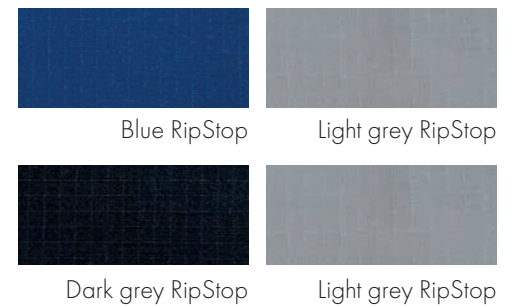

Sands 250

Fjord 300



Sands AZUR

Fjord COAL

AZUR • COAL



Fjord is a complete awning made of quality acrylic fabric. Its depth of 3 meters and high performance make it a class awning.

Now available in two versions: Coal and Azur.

Also available the Sands 250 model, which maintains the same specifications but with a depth of 250 cm.

Specifications

-  Suitable for caravans
-  Acrylic fabric
-  Sizes from S (786 cm) to ZZ (1235 cm)
-  300 cm depth
250 cm for Sands
-  Interior mudflap
-  Front extra ventilation

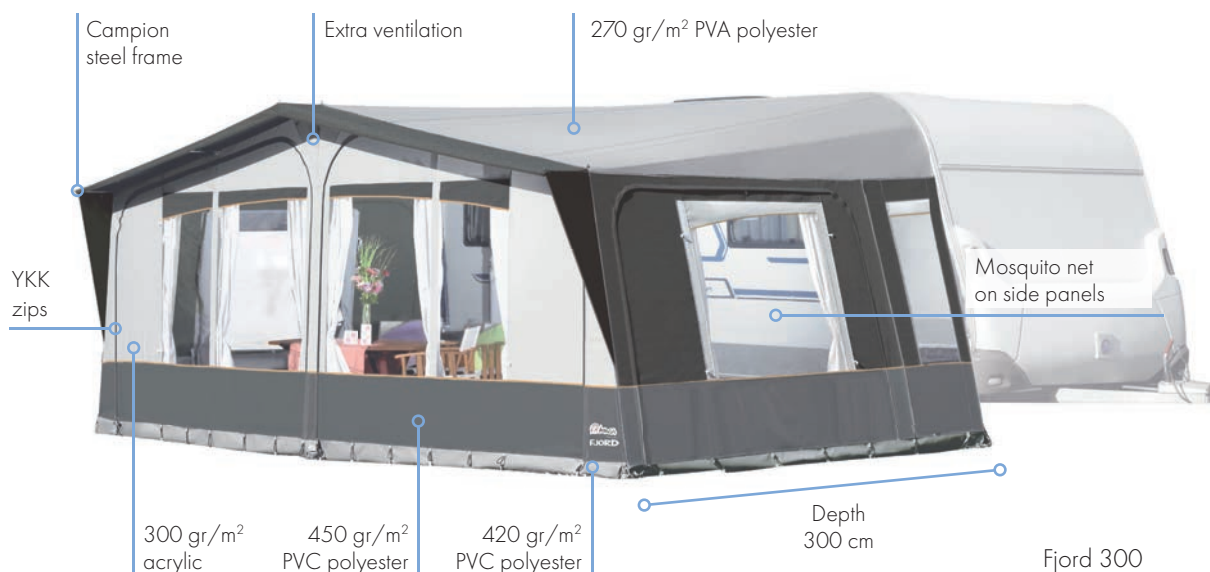

Sizes

Sands 250

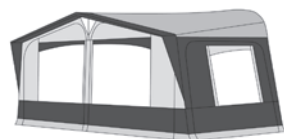

S-T-U-V

Fjord 300

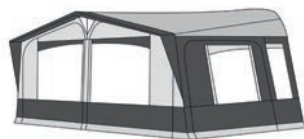

S-T-U-V

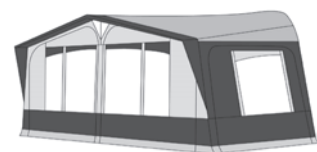

W-X-Y-Z-ZZ

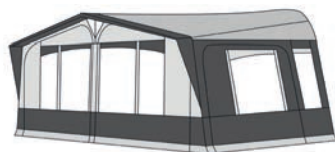

W-X-Y-Z-ZZ

Optional accessories

- Fibreglass frame
- Front sun canopy
- Roof liner (velum)
- Fix-On
- Verandah bars
- Annexe Luxe or Storage
- UNI storm straps

Color scheme



Anthracite acrylic

Grey acrylic

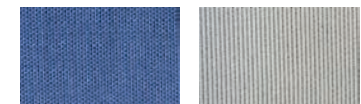

Blue acrylic

Grey acrylic

Curtains included
#7 Whites

Stela

250

300

350



Stela 350



Stela 250

Available in three versions: standard in 250 cm depth, with extra space in 300 cm and also in 350 cm. It is an attractive awning, with a new and refined design and an elegant combination of colors.

The front consists of 4/6 panels, all removable and interchangeable, 3/4 of them consist of fixed windows and smooth design, the other/s has a sliding door to any position thus offering all the possibilities of transformation.

Each side is removable and has a door and a folding window with mosquito net. In the 350 cm model we add a fixed window.

This model can be completely closed, since it has covers on the windows. It can also be used as a sunshade and, optionally, the panels can be installed as front and side balconies.

Specifications

-  Suitable for caravans
-  Built in PVA polyester
-  Campion galvanized steel frame 25/22 mm
-  Sizes from S (786 cm) to ZZ (1235 cm)
-  Depth 250 · 300 · 350 cm + 30 cm canopy
-  Zip down covers
-  Mosquito net on each side panel
-  Front extra ventilation
-  Double mudflap

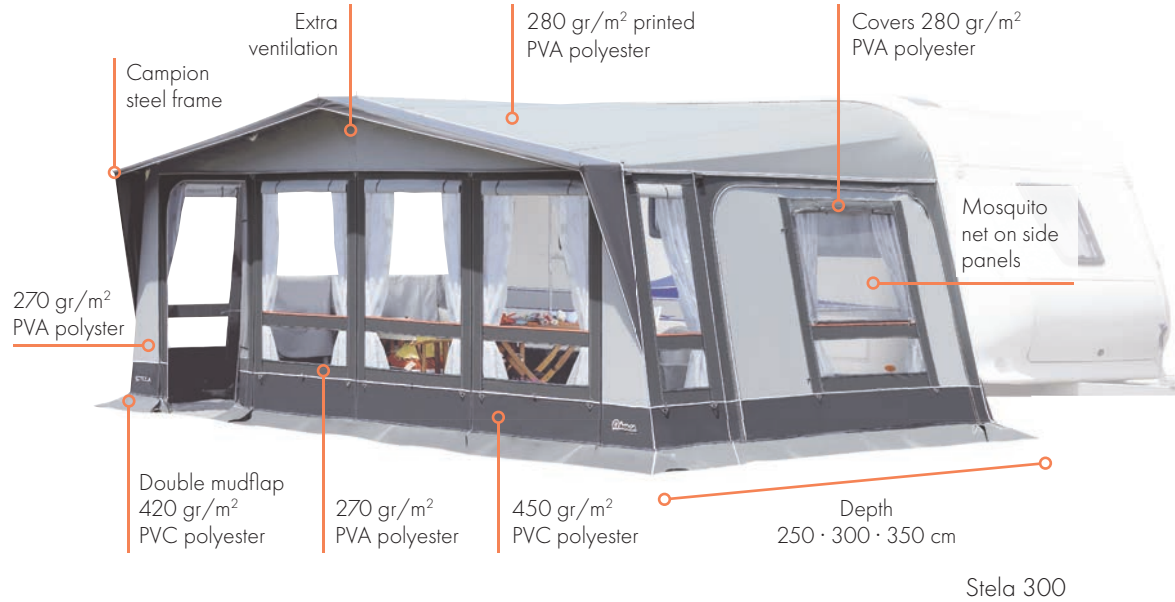

Sizes



S-T-U-V-W



X-Y-Z-ZZ



Optional accessories

- Fibreglass frame for Stela 250 and 300
- Front sun canopy
- Roof liner (velum)
- Fix-On
- Verandah bars
- PVC polyester roof for Stela 250 and 300
- Verandah bars
- Annexe Luxe or Storage
- UNI storm straps

Color scheme



Anthracite PVA



Printed light grey PVA



Curtains included #7 Whites

Fusion

250
300



It is an awning with a new design and color combination for a model made entirely of PVC polyester, a feature that gives great resistance to weathering and great ease of cleaning.

The front is divided into 2/3 removable panels and the sides are removable and their windows, folding, incorporate mosquito net.

It has darkened covers in all windows.

Specifications

-  Suitable for caravans
-  Built in PVC polyester
-  Champion galvanized steel frame 25/22 mm
-  Sizes from R (710 cm) to Y (1135 cm)
-  Depth 250 · 300 cm + 30 cm canopy
-  Zip down covers
-  Mosquito net on each side panel
-  Front extra ventilation

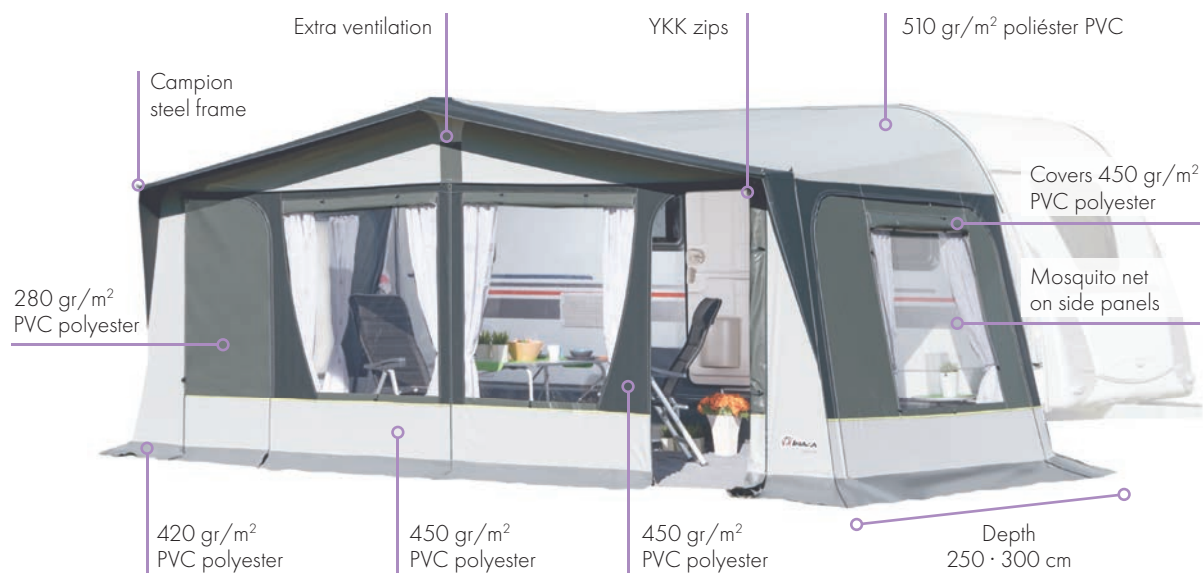

Sizes

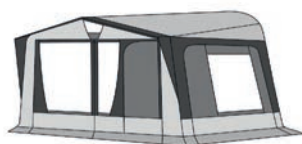

R-S

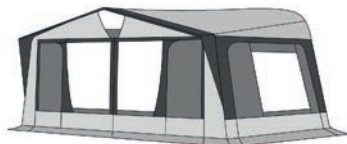

T-U-V-W

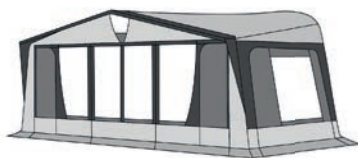

X-Y

Optional accessories

- Fibreglass frame
- Front sun canopy
- Roof liner (velum)
- Fix-On
- Verandah bars
- Annexe UNI Luxe or UNI Storage
- UNI storm straps

Color scheme



Anthracite PVC



Light grey PVC

Curtains included
#7 Whites

Galileo

250s









270s



Awning manufactured entirely in PVC polyester long-lasting, feature that gives great resistance to weathering and great ease of cleaning.

It is a practical and flexible awning. The front is divided into 2/3 removable panels and consists of 2/3/4 fixed windows and 1/2 doors. Each side panel, also removable, has a door and a folding window with mosquito net. It is possible to attach an optional annex. All windows are provided with outer covers with zippers.

Specifications

-  Suitable for caravans
-  Built in PVC polyester
-  Campion galvanized steel frame 25/22 mm
-  Sizes from R (710 cm) to X (1085 cm)
-  Depth 250 · 270 cm + 30 cm canopy
-  Zip down covers
-  Mosquito net on each side panel
-  Front extra ventilation

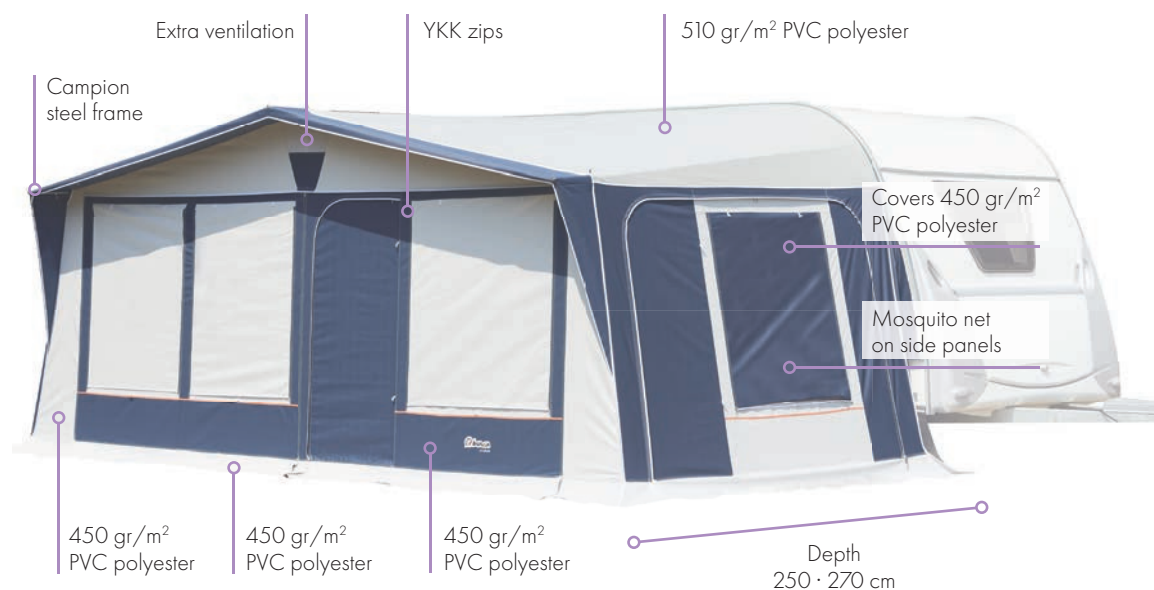

Sizes

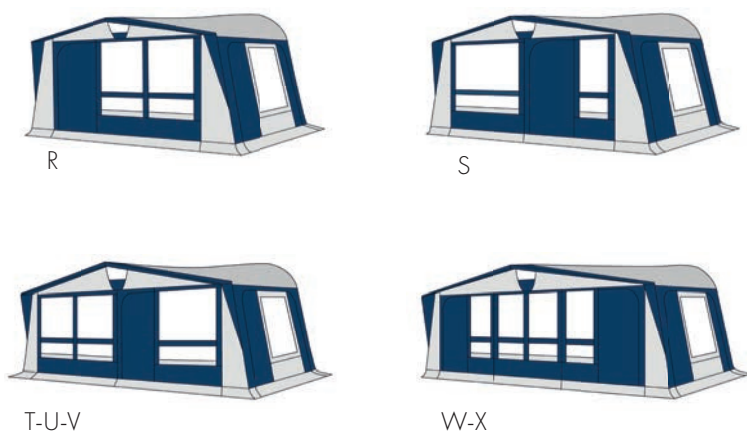

Optional accessories

- Fibreglass frame
- Front sun canopy
- Roof liner (velum)
- Fix-On
- Verandah bars
- Annexe UNI Luxe or UNI Storage
- UNI storm straps

Color scheme



Blue PVC



Light grey PVC

Curtains included
#8 Marina



Sintra 250



It is an awning with a combination of strength and functionality in a current design. Made of PVC polyester, feature that gives great resistance to weathering and great ease of cleaning.

Available with a depth of 250 cm. The front is divided into 2/3 removable panels and the sides are removable and its windows, folding, incorporate mosquito net.

Specifications

-  Suitable for caravans
-  Built in PVC polyester
-  Champion galvanized steel frame 25/22 mm
-  Sizes from R (710 cm) to Y (1135 cm)
-  Depth 250 cm + 30 cm canopy
-  Mosquito net on each side panel
-  Front extra ventilation

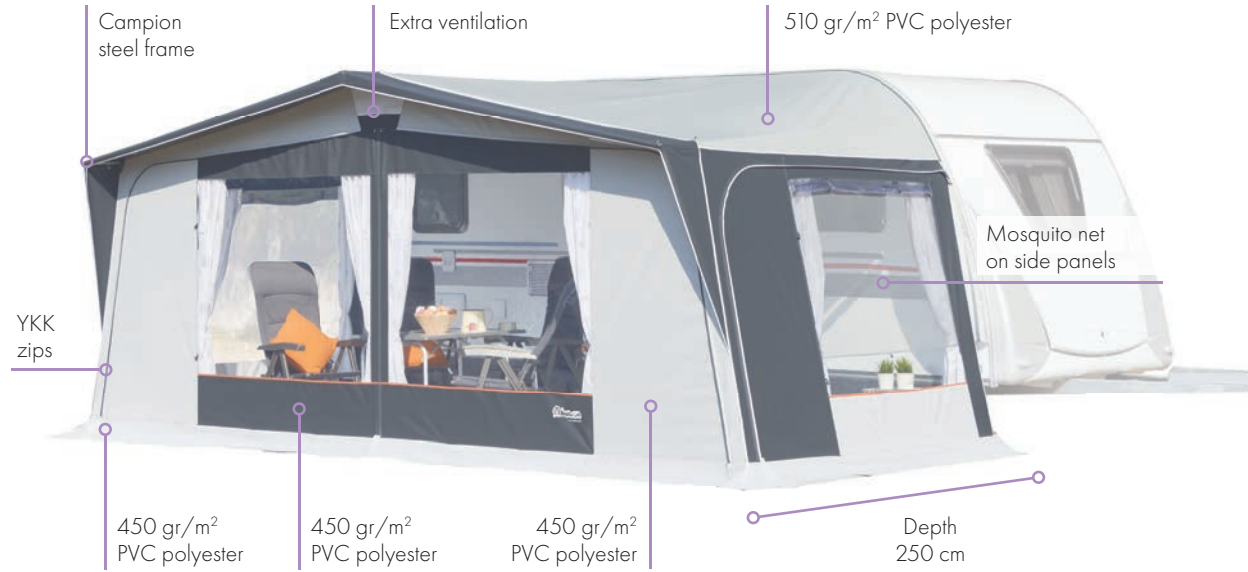

Sizes

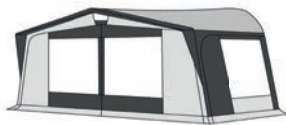

R-S-T-U-V

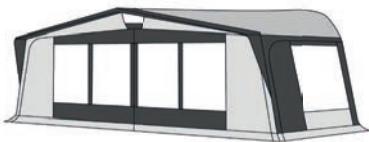

W-X

Optional accessories

- Fibreglass frame
- Front sun canopy
- Roof liner (velum)
- Fix-On
- Verandah bars
- Annexe UNI Luxe or UNI Storage
- UNI storm straps

Color scheme

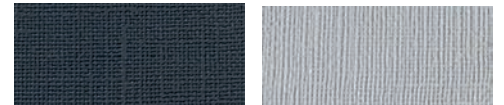

Anthracite PVC

Light grey PVC



Curtains included
#8 Marina

Alpes

320

380

420

 TENCATE



CLASSIC

Alpes 380 • 420









Alpes 320

This awning has a roof with a double apex and reinforced seams. It is very strong and with a harmonious design. This is a universal awning and may be adapted to most types of caravan, since the fixing system are adjustable in height. The fixing system to the caravan consists of foam filled pads and Fix-On system adaptable to any surface and it is reinforce with side legs.

The only requirement is that your caravan has enough straight awning channel for the correct fitting of the porch. The winter reinforcement kit (optional) is recommended when the awning is used in areas with snow and rough weather.

The front panel has two large fixed windows. It may be removed and may also be used as a verandah. Each side panel has a door and a window (on the right panel it may be rolled up and has a mosquito net).

Specifications

-  Winter use
-  Built in PVA polyester
-  Champion galvanized steel frame 25/22 mm
-  Depth 240 cm + 20 cm canopy
-  Zip down covers
-  Mosquito net on right panel
-  Extra ventilation on one side

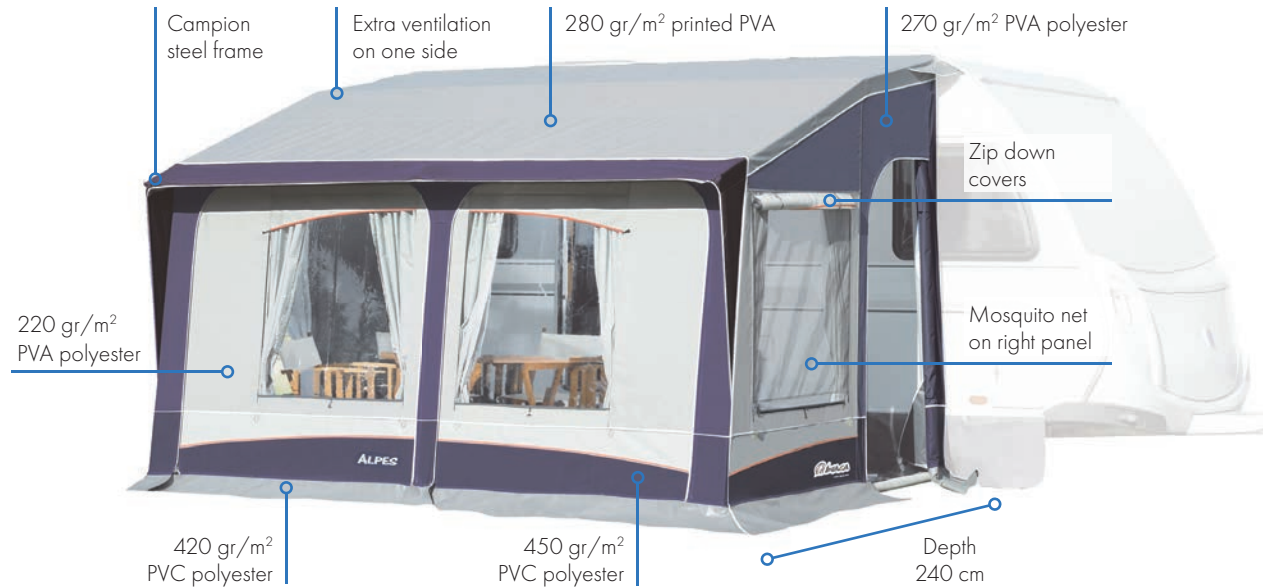

Sizes



320



380 · 420

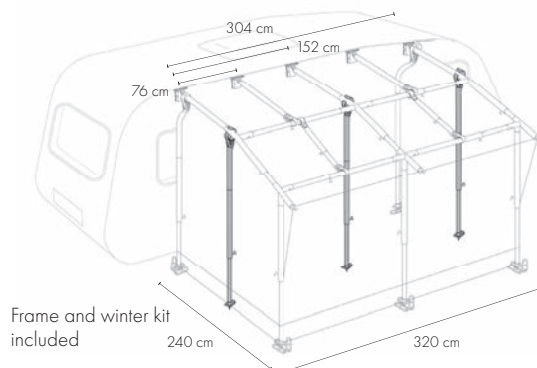

Frame and winter kit included

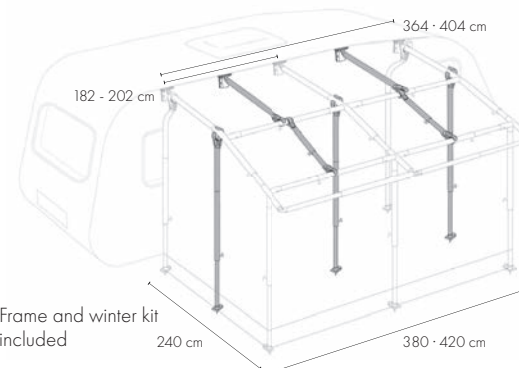

Frame and winter kit included

Optional accessories

- Roof liner (velum)
- Fix-On
- Front verandah bar
- Reinforcing poles

Color scheme

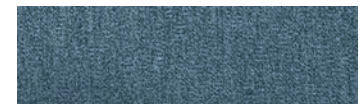

Metallic dark blue PVA



Light grey PVA

Curtains included
#2 Blue stars

Alpes

320 · 380 · 420



AZUR

Alpes 380 · 420









Alpes 320

This awning has a roof with a double apex and reinforced seams. Built in 300 gr acrylic and PVA polyester. It is very strong and with a harmonious design. This is a universal awning and may be adapted to most types of caravan, since the fixing system are adjustable in height. The fixing system to the caravan consists of foam filled pads and Fix-On system adaptable to any surface and it is reinforce with side legs.

The only requirement is that your caravan has enough straight awning channel for the correct fitting of the porch. The winter reinforcement kit (optional) is recommended when the awning is used in areas with snow and rough weather.

The front panel has two large fixed windows. It may be removed and may also be used as a verandah. Each side panel has a door and a window (on the right panel it may be rolled up and has a mosquito net).

Specifications

-  Winter use
-  Built in acrylic 300 gr
-  Campion galvanized steel frame 25/22 mm
-  Depth 240 cm + 20 cm canopy
-  Zip down covers
-  Mosquito net on right panel
-  Extra ventilation on one side



Sizes



320

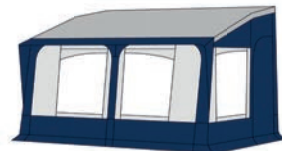

380 · 420

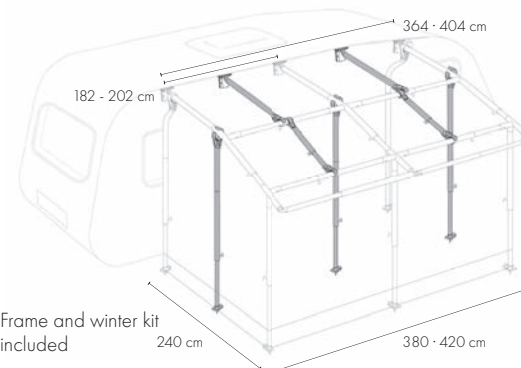
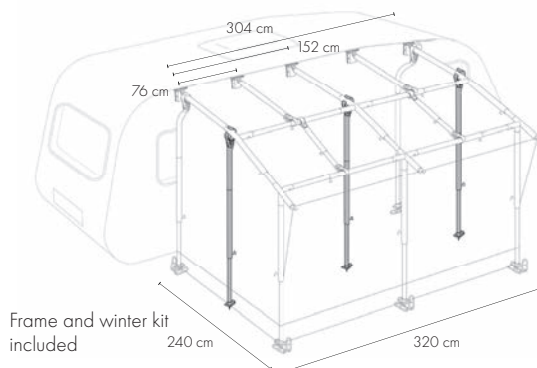

Optional accessories

- Roof liner (velum)
- Fix-On
- Front verandah bar
- Reinforcing poles

Color scheme



Blue acrylic



Grey acrylic

Curtains included
#2 Blue stars

Puigmal 250









Strong and compact winter awning, with reinforced structure and double apex roof. Of standard dimensions and for that reason only adaptable to caravans with the suitable dimensions (+/- 265 cm) of straight guide.

It is adaptable to any caravan because all the anchors are adjustable in height. The fixation of the sides to the caravan is made of rubber-foam that can be welded to any surface and reinforced by side legs.

A new ventilation screen is incorporated in the side panel. The front consists of a large fixed window. Each side has a door. The whole set is designed to ease a quick assembly and give an optimal service in the space-functionality relationship.

Specifications

-  Winter use
-  Built in PVC polyester
-  Champion galvanized steel frame 25/22 mm
-  Depth 180 cm
-  Double apex roof
-  Front covers
-  Extra ventilation on one side



Sizes

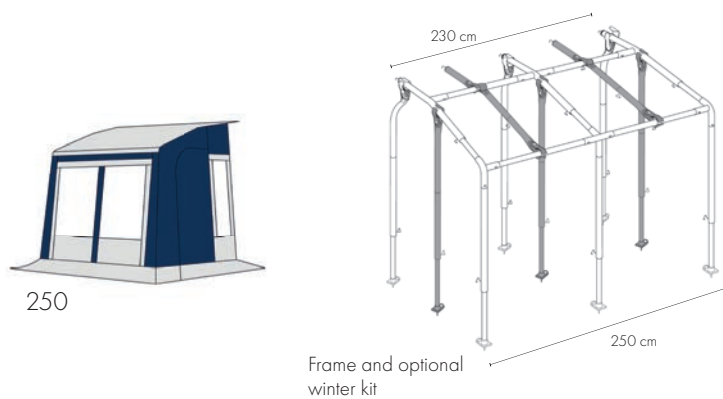

Optional accessories

- Roof liner (velum)
- Fix-On
- Winter kit

Color scheme

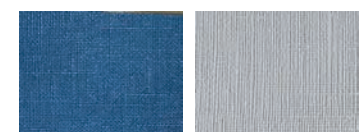

Blue PVC

Grey PVC

Curtains included
#2 Blue stars





This awning is manufactured in polyester acryl and is provided of alloy frame. This is a universal awning and may be adapted to most types of caravan, since the fixing system are adjustable in height.

The fixing system to the caravan consists of foam filled pads and Fix-On system adaptable to any surface and it is reinforced with side legs. The only requirement is that your caravan has enough straight awning channel for the correct fitting of the porch (360 cm).

The front panel is removable and has two fixed windows and two doors. Each side panel is removable and has a door and a roll up window with mosquito net in one of the panels.

Specifications

-  Suitable for caravans
-  Depth 240 cm
-  Built in polyester/acryl
-  Interior mudflap
-  Aluminium frame
-  Mosquito net on one side

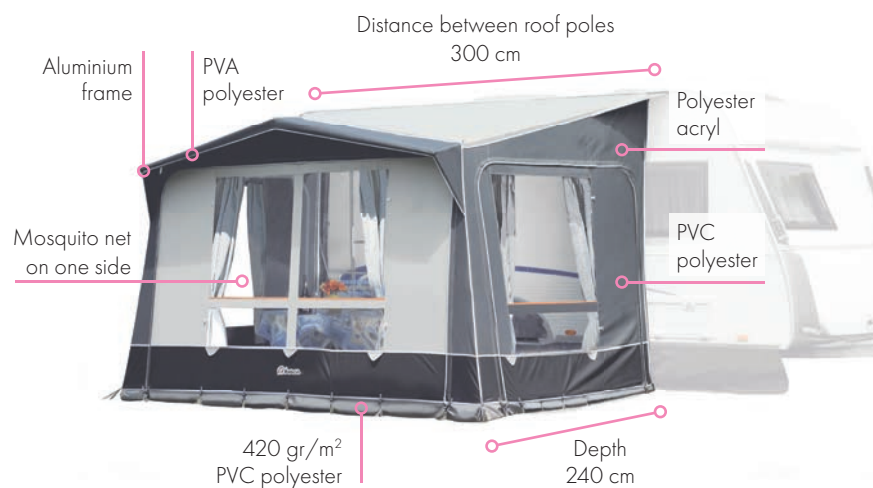

Sizes



360

Optional accessories

- Front verandah bar
- Side verandah bar
- Inner room
- Fix-On
- UNI storm straps

Color scheme



Anthracite polyester acryl



Light grey polyester

Curtains included
#7 Whites

Mercury with side verandah bar



Mercury as canopy



Jeroboam 360

A very flexible porch awning to fit caravans.

Manufactured in top quality materials, and provided with three interchangeable panels.

Available with with fiberglass frame.

Specifications

 Suitable for caravans

 Built in PVA polyester

 Fibreglass frame

 Depth 250 cm + 30 cm canopy

 Mosquito net on side panels

 Interior mudflap

 Ventilation in front panel

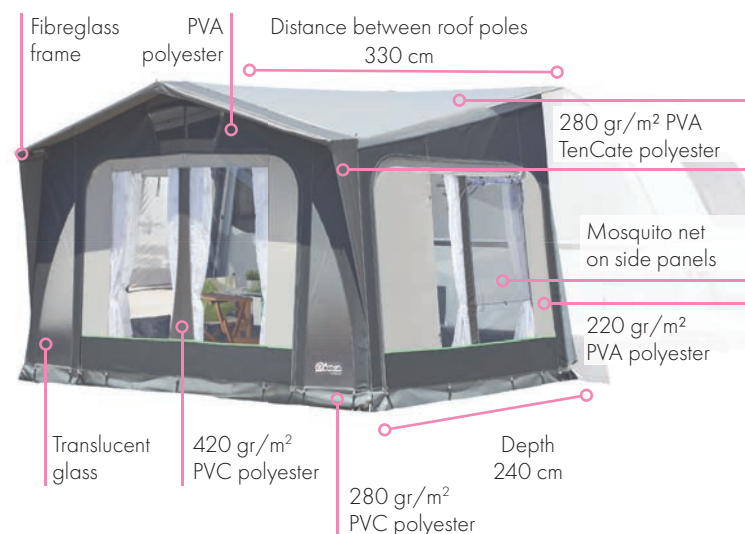

Sizes



360

Optional accessories

- Front verandah bar
- Side verandah bar
- Annexes
- UNI storm straps

Color scheme

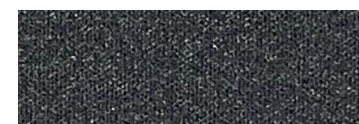

Anthracite PVA polyester



Light grey PVA polyester



Curtains included
#7 Whites





Front sun canopy

Specifications



Built in PVA polyester



Campion galvanized steel frame



Sizes from S (786 cm) to Z (1185 cm)



Depth 240 cm

Color scheme



Silver grey



Side panel

The front sun canopy is a product that helps to expand the space and give greater comfort.

It is breathable and lightweight, includes the frame and pegs for its assembly. It is coupled to its awning under the visor through the tension poles.

It is essential to provide the year of manufacture of its awning or the measurement of the front.

The side panel has a transparent window, is adaptable to both sides and is attached to the roof pole. The frame and accessories for correct fitting are included..

Ibiza canopy



Specifications



Built in PVA polyester



Galvanized steel legs



Sizes from R (710 cm) to Z (1185 cm)



Depth 240 cm

Color scheme



Silver grey



Side panels

Lightweight and easy to assemble canopy. Manufactured from PVA polyester, it is breathable and lightweight. Supplied as standard with steel legs, the full frame is sold separately but also fits with Prenox 270 or fibreglass 270 frames.

Optional side panels can be linked to the canopy through a straight zip. The side panels are interchangeable with each other. They are available with window or without window, on both sides to combine them to the desired taste and needs. The mudflap is optional.

Color scheme



Blue RipStop



Light grey RipStop

Verona canopy



Suitable to both, caravan and motorhome (any FIAMMA F45, CaravanStore and Omnistore canopy). The lightest of the canopies, conceived to provide a wide area of shade in a few minutes of assembly.

Specifications



Suitable for caravans and motorhomes



Built in PVA polyester RipStop



Lengths 240, 300, 350, 400, 450, 500 and 550 cm



Depth 240 cm

Color scheme

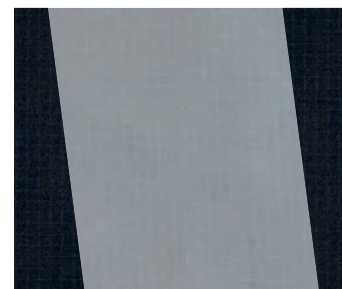

Dark and light grey

Annexes



An extra space attached to the side panel of your awning. Manufactured from PVA polyester and PVC mudflaps. Ideal for use as storage room, kitchen space or bedroom (inner tent optional).

Luxe UNI Luxe

It has a fixed and opaque window on each side. In the front a door and two windows, one of them folding and with mosquito net.

Storage UNI Storage

Annex without windows to get more privacy.

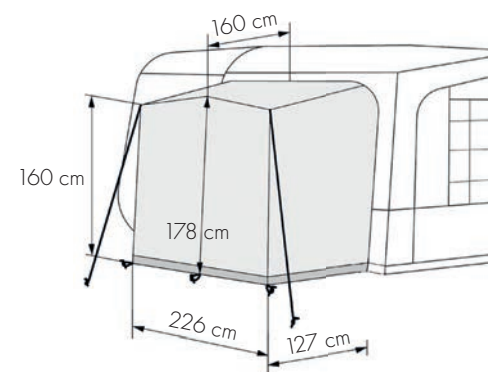

Storage and Luxe para Stela, Sands, Fjord and Jeroboam.
UNI Storage and UNI Luxe for Galileo, Siena and Fusion.

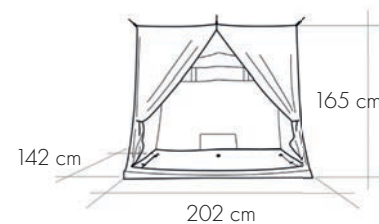

Optional inner room

Windscreens



A windscreen is the ideal item to isolate yourself from the wind and preserve privacy. INACA windscreens are lightweight and breathable, frame and pegs are included. They are made of polyester acryl with windows or without windows.

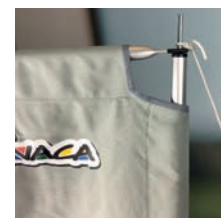
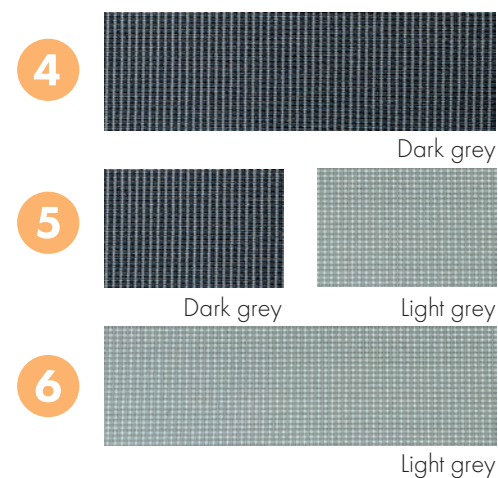
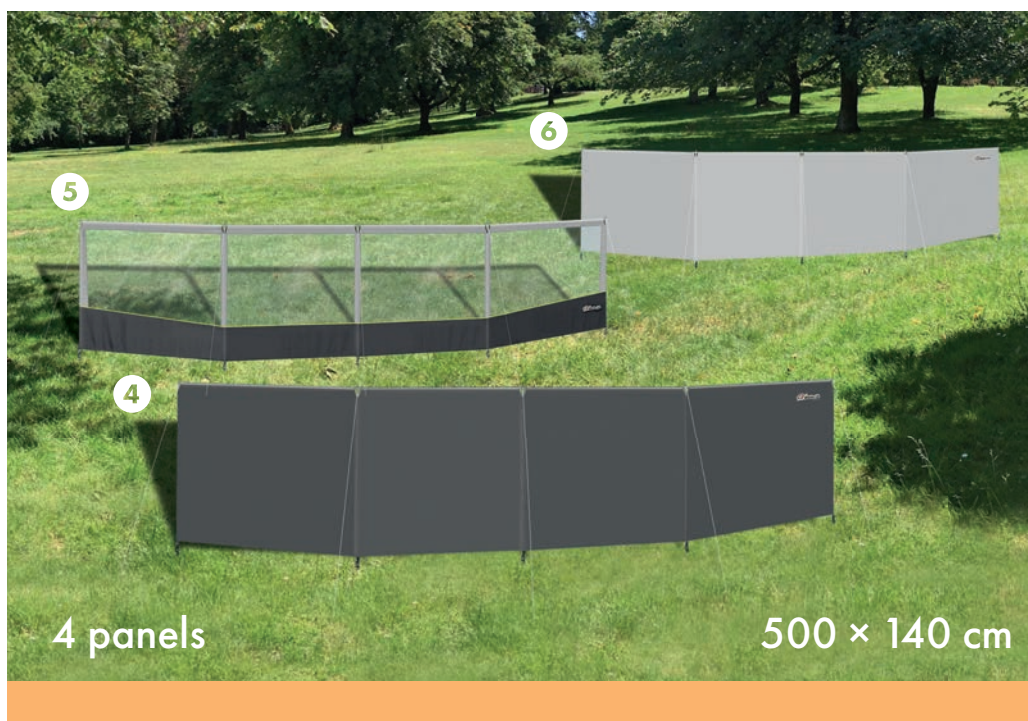
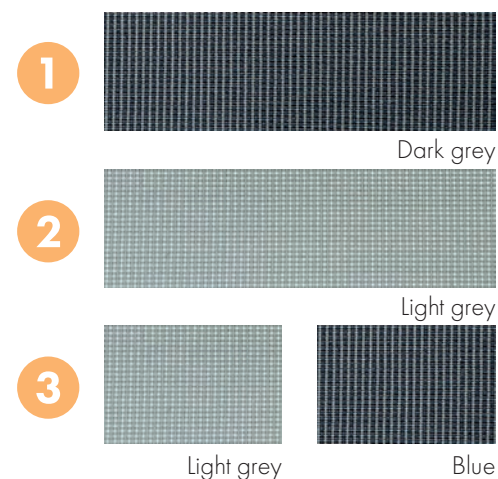

Kitchen tents



Victoria



Nepal



Arosa



Teide

"A kitchen tent must be practical, comfortable, multifunctional and resistant." Under this paradigm we have designed the INACA kitchen tents that this season provides a wide range of possibilities. For all of them we certify great resistance, maximum quality in materials and great care in manufacturing.

We have different accessories for our kitchens such as floors, tiles and hangers.

Specifications



Central height 205 cm
Length 160 cm
Depth 120 cm



Built in PVC polyester



Mosquito net on the back window



Includes 4 curtains
#6 Blue squares



Weight 15 kg

Inca



Color scheme



Grey



Light grey







Java

Inca

Messina

Java

Specifications

-  Central height 210 cm
Length 180 cm
Depth 145 cm
-  Built in PVC polyester
-  Mosquito net on the back window
-  Includes 6 curtains
#6 Blue squares
-  Weight 20 kg



Color scheme

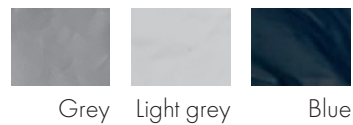

Arosa

Specifications

-  Central height 210 cm
Length 300 cm
Depth 180 cm
-  Built in PVC polyester
-  Mosquito net on 3 windows:
sides and back panels
-  Blind covers
in all windows
-  Includes 9 curtains
#6 Blue squares
-  Weight 33 kg



Color scheme

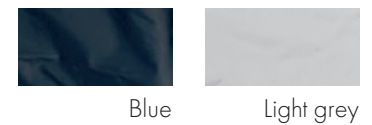



Victoria

Specifications

 Central height 215 cm
Length 210 cm
Depth 145 cm

 Built in PVC polyester

 Mosquito net on 3 windows:
sides and back panels

 Blind covers
in all windows

 Includes 6 curtains
#6 Blue squares

 Weight 25 kg



Color scheme

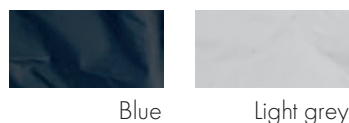

Nepal

Specifications

 Central height 220 cm
Length 240 cm
Depth 145 cm

 Built in PVC polyester

 Mosquito net on 3 windows:
sides and back panels

 Blind covers
in all windows

 Includes 9 curtains
#6 Blue squares

 Weight 31 kg



Color scheme

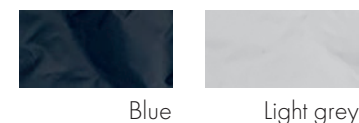



Messina

Specifications

 Central height 210 cm
Length 190 cm
Depth 145 cm

 Built in PVC polyester

 Mosquito net on 3 windows:
sides and back panels

 Blind covers
in all windows

 Includes 6 curtains
#7 Whites

 Weight 21 kg



Color scheme

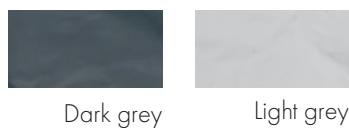

Teide

Specifications

 Central height 190 cm
Length 160 cm
Depth 195 cm

 Built in PVC polyester

 Mosquito net
on window

 Blind cover in
back window

 Weight 22 kg



Color scheme

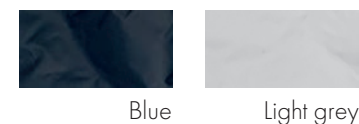

Curtains

We show you the range of INACA curtains and which awning models have them included.

1 Grey stars



Alpes classic, Dynamic grey, CS-Activa, Fjord coal, Sands coal and Mercury

2 Blue stars



Alpes azur, Dynamic blue, Fjord azur, Sands azur and Puigmal

6 Blue squares



Inca, Java, Nepal, Victoria and Arosa

7 Whites



Atmosphere, Fusion, Stela, Venecia, Jeroboam and Messina

8 Marina



Sintra and Galileo



Thermal blinds

External protection against cold, heat and light. Made of grey padded PVC. Also available for motorhome cabins. Aluminized thermal blinds available for the interior.



Lago curtains

Lago curtains protects from light, heat and insects. Available in several sizes and color combinations. Ideal for the awning door as well as the door of the caravan.



Mosquito net side panel

It is attached to the awning by zipper. It adjusts to any INACA awning with an annex capacity, such as Stela, Sands, Fjord, Jeroboam and Motor Annexe.



Inner roof -velum-

Ideal to avoid condensation and achieve better thermoinsulation.

It is easily attached to the frame through PVC hooks and to the back inner beading through special fixations.

Specifications



Built in polyester cotton



Sizes from R (710 cm) to ZZ (1235 cm)



To fit awnings with 250, 270, 300 or 350 cm depth and winter awnings

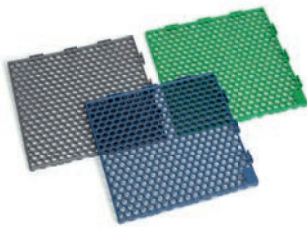

Plastic matting

Easy to assembly and very resistant.
Available in 33 × 33 cm.



UNI storm straps

The UNI straps provide total security of support in the awning. To strengthen the anchor of its awning and even improve the tension of the front. Very allowed for areas of strong winds.



Wheel cover and tow-bar cover

Protection against drying and corrosion. Manufactured of PVC polyester and adjustable to all caravans. Also available for double axis caravans.



We show you a range of colors with a simple design that matches with all tents. The carpets are very comfortable thanks to their low weight and flexible weave, are easy to handle and great to walk on.

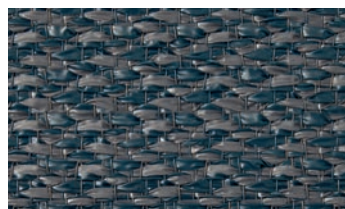

NEW **North** -dark blue- 425 g/m²
Width: 250 · 300 · 350 cm



NEW **Dawn** -light grey- 425 g/m²
Width: 250 · 300 · 350 cm

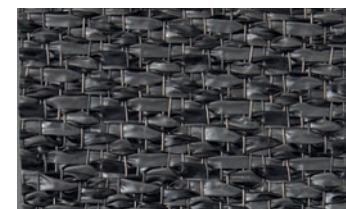

NEW **Flint** -dark grey- 425 g/m²
Width: 250 · 300 · 350 cm



Light grid
Width: 250 cm - Weight: 415 g/m²

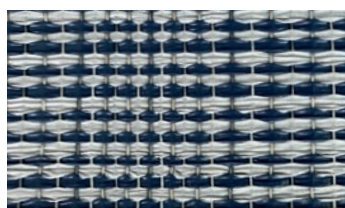

Idun -dark blue-
Width: 250 · 300 cm - Weight: 425 g/m²



Freja -light grey-
Width: 250 · 300 cm - Weight: 425 g/m²

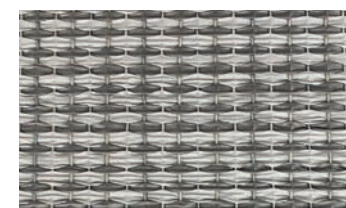

Trud -dark grey-
Width: 250 · 300 cm - Weight: 425 g/m²

Poles champion



Reinforcement roof pole Prenox 270 cm, AX
Reinforcement roof pole Prenox 300 cm, AX



Reinforcement roof pole 4-B 62 · 100 cm
Reinforcement roof pole 4-B 95 · 130 cm



Reinforcement leg pole Prenox 235 cm height
Reinforcement leg pole Prenox 245 cm height
Also available in fibreglass



Front verandah bar R, S, T, U 220 cm
Front verandah bar V, W, X 325 cm



Side verandah bar



Reinforcement roof pole fibreglass 270 cm, AX
Reinforcement roof pole fibreglass 300 cm, AX



Front verandah bar fibreglass R, S, T, U 240 cm
Front verandah bar fibreglass V, W, X 325 cm



Fix-On

This fixing system, very light and easy, is linked to the second beading on the canvas of your awning, enabling you to attach the roof poles without the need to fix brackets on your caravan.

| AWNINGS RANGE | CARAVANS AND MOTORHOMES | | | CARAVANSTORE | CARAVAN | | |
|-----------------------------|--|--|--|--|--|--|--|
| Models | Atmosphere | Dynamic | Venecia | CS-Activa y XL | Sands | Fjord | Stela |
| Sizes | 300, 350 and 400 cm | 300 to 550 cm | 350 and 400 cm | 225 to 550 cm | S, T, U, V, W, X, Y, Z, ZZ | S, T, U, V, W, X, Y, Z, ZZ | S, T, U, V, W, X, Y, Z, ZZ |
| Perimeters | - | - | - | - | 786 - 1235 | 786 - 1235 | 786 - 1235 |
| Depth + canopy | 250 cm | to fit canopy 250 cm | to fit canopy 250 cm | as CaravanStore | 250 + 30 cm | 300 + 30 cm | 250 · 300 · 350 + 30 cm |
| Length | 300, 350 and 400 cm | base 300 cm + panels | 350 or 400 cm | as CaravanStore | - | - | - |
| Frame | air and aluminium | clip system | clip system | steel · easy clip | steel | steel | steel |
| Fixing system | - | FIAMMA kit | FIAMMA kit | FIAMMA kit | hook | hook | hook |
| Removable front panel | rolls-sideways | in panels | one piece | ✓ | 2 panels | 2 panels | 4/6 panels |
| Removable side panel | ✓ | ✓ | ✓ | ✓ | ✓ | ✓ | ✓ |
| Side panel windows | removables | removables | removables | removables | removables | removable and fix | removable and fix |
| Side panel mosquito net | ✓ | ✓ | ✓ | ✓ | ✓ | ✓ | ✓ |
| Roof material | RipStop polyester | canopy | canopy | canopy | PVA TenCate | PVA TenCate | printed PVA |
| Roof color | dark grey | canopy | canopy | canopy | grey | grey | grey |
| Wall materials | RipStop polyester | RipStop polyester | RipStop polyester | RipStop polyester | acrylic | acrylic | PVA polyester |
| Wall colors | dark and light grey | grey or blue and grey | dark and light grey | dark and light grey | grey or blue and grey | grey or blue and grey | silver and grey |
| Awning skirt | RipStop polyester | RipStop polyester | RipStop polyester | RipStop polyester | PVC polyester | PVC polyester | PVC polyester |
| Mudflaps | PVC polyester | PVC polyester | PVC polyester | PVC polyester | PVC polyester | PVC polyester | PVC polyester |
| Number of doors | 2 doors | 3 (1 of them mobile) | 1 door | 1 mobile | 4 doors | 4 doors | 3 · 4 doors |
| Window covers | inners | - | - | - | - | - | ✓ |
| Upper ventilation | ✓ | - | - | - | ✓ | ✓ | ✓ |
| Curtains | #7 whites | #1 grey or #2 blue | #7 whites | #1 grey | #7 whites | #7 whites | #7 whites |
| Optional accessories | | | | | | | |
| Front verandah bar | - | - | - | - | ✓ | ✓ | ✓ |
| Side verandah bar | - | - | - | - | ✓ | ✓ | ✓ |
| Standard room | - | - | - | - | ✓ | ✓ | ✓ |
| Annexes | - | - | - | - | ✓ | ✓ | ✓ |
| Fix-On system | - | - | - | - | ✓ | ✓ | ✓ |
| Steel frame | - | - | - | - | standard | standard | standard |
| Fibreglass frame | - | - | - | - | ✓ | ✓ | 250 and 300 |
| Option grey PVC roof | - | - | - | - | - | - | 250 and 300 |
| Double mudflap | - | - | - | - | - | - | standard |
| Materials used | | | | | | | |
| Side and front walls | 190 gr/m ² PVA polyester | 190 gr/m ² PVA polyester | 190 gr/m ² PVA polyester | 190 gr/m ² PVA polyester | 300 gr/m ² acrylic | 300 gr/m ² acrylic | 260 and 270 gr/m ² PVA polyester |
| Roof | 190 gr/m ² PVA polyester | canopy | canopy | canopy | 270 gr/m ² PVA polyester | 270 gr/m ² PVA polyester | 280 gr/m ² printed PVA polyester |
| Mudflap | 420 gr/m ² PVA polyester | 420 gr/m ² PVA polyester | 420 gr/m ² PVA polyester | 420 gr/m ² PVA polyester | 420 gr/m ² PVA polyester | 420 gr/m ² PVA polyester | 420 gr/m ² PVA polyester |

| CARAVAN | | | WINTER | | | LIMITED SERIE | |
|--|--|--|--|--|--|--|--|
| Fusion | Galileo | Sintra | Alpes classic | Alpes azur | Puigmal | Mercury | Jeroboam |
| R, S, T, U, V, W, X, Y | R, S, T, U, V, W, X | R, S, T, U, V, W, X, Y | 320 · 380 · 420 | 320 · 380 · 420 | 250 | 360 | 360 |
| 710 - 1135 | 710 - 1085 | 710 - 1135 | - | - | - | - | - |
| 250 · 300 + 30 cm | 250 · 270 + 30 cm | 250 + 30 cm | 240 + 20 cm | 240 + 20 cm | 180 cm | 240 + 20 cm | 250 + 30 cm |
| - | - | - | 320, 380 or 420 cm | 320, 380 or 420 cm | 250 cm | 360 cm | 360 cm |
| steel | steel | steel | steel | steel | steel | aluminium | fibreglass |
| hook | hook | hook | hook | hook | hook | hook | hook |
| 1(R)/2/3 panels | 1(R)/2/3 panels | 2/3 panels | 1/2 panels | 1/2 panels | - | ✓ | ✓ |
| ✓ | ✓ | ✓ | - | - | - | ✓ | ✓ |
| removables | removables | removables | removable and fix | removable and fix | - | removables | removables |
| ✓ | ✓ | ✓ | right side panel | right side panel | - | left side panel | ✓ |
| PVC polyester | PVC polyester | PVC polyester | PVA polyester | PVA polyester | PVC polyester | printed PVA | printed PVA |
| grey | grey | grey | grey | grey | grey | grey | grey |
| PVC polyester | PVC polyester | PVC polyester | poliéster PVA | acrylic | PVC polyester | polyester acryl | PVC and PVA polyester |
| 3 tone grey | blue and grey | dark and light grey | blue and grey | blue and grey | blue and grey | dark and light grey | dark and light grey |
| PVC polyester | PVC polyester | PVC polyester | PVC polyester | PVC polyester | PVC polyester | PVC polyester | PVC polyester |
| PVC polyester | PVC polyester | PVC polyester | PVC polyester | PVC polyester | PVC polyester | PVC polyester | PVC polyester |
| 3 · 4 doors | 3 · 4 doors | 4 doors | 2 · 4 doors | 2 · 4 doors | 2 doors | 4 doors | 2 doors |
| ✓ | ✓ | - | ✓ | ✓ | front panel | - | - |
| ✓ | ✓ | ✓ | side panel | side panel | side panel | ✓ | ✓ |
| #7 whites | #8 marina | #8 marina | #2 blue | #2 blue | #2 blue | #7 whites | #7 whites |
| Optional accessories | | | | | | | |
| ✓ | ✓ | ✓ | ✓ | ✓ | ✓ | ✓ | ✓ |
| ✓ | ✓ | ✓ | - | - | - | ✓ | ✓ |
| ✓ | ✓ | ✓ | - | - | - | ✓ | ✓ |
| ✓ | ✓ | ✓ | - | - | - | - | ✓ |
| ✓ | ✓ | ✓ | ✓ | ✓ | - | ✓ | ✓ |
| standard | standard | standard | standard | standard | standard | - | - |
| ✓ | ✓ | ✓ | - | - | - | - | standard |
| - | - | - | - | - | - | - | - |
| ✓ | ✓ | - | - | - | - | - | - |
| Materials used | | | | | | | |
| 450 gr/m ² PVC polyester | 450 gr/m ² PVC polyester | 450 gr/m ² PVC polyester | 220 and 270 gr/m ² PVA polyester | 300 gr/m ² acrylic | 420 gr/m ² PVC polyester | polyester acryl | 220 and 260 gr/m ² PVA polyester |
| 510 gr/m ² PVC polyester | 510 gr/m ² PVC polyester | 510 gr/m ² PVC polyester | 280 gr/m ² PVA polyester | 280 gr/m ² PVA polyester | 510 gr/m ² PVC polyester | PVA polyester | 280 gr/m ² PVA polyester |
| 420 gr/m ² PVA polyester | 420 gr/m ² PVA polyester | 420 gr/m ² PVA polyester | 420 gr/m ² PVA polyester | 420 gr/m ² PVA polyester | 420 gr/m ² PVA polyester | 420 gr/m ² PVA polyester | 420 gr/m ² PVA polyester |

How to choose your awning?

INACA offers a wide range of awnings. Each of them has different performance qualities to satisfy every caravanner's specific needs. Therefore, it is very important to choose an awning that suits your needs. Do not hesitate to ask your distributors for advice. Their professional assessment will help you with your choice.

Which is the most suitable awning for your caravan?

When buying your awning, our distributors will need to know the brand, model, and year of your caravan. If you are unsure about any of these facts, INACA offers you a quick and efficient guide classifying the awning's size according to the perimeter of each caravan.

For instance:

If your caravan has a perimeter of 956 cm (measurement from A to B), the appropriate awning for you is V-950.



Some important suggestions

Always pay special attention at measuring the perimeter of your caravan; the correct selection of the size you require is a determinant factor for the proper erection of your awning. According to the different sizes the distribution of the front panel may vary. Pay attention at the diagrams in order to avoid misunderstandings. Never pack your awning when wet. Never clean your awning with products that may damage the materials. When you use your PVC awning for the first time under rainy conditions, it is possible that the seams may leak initially. The problem will disappear when the stitching has swollen into place over the following days use.

| Sizes | | | Weights (kg) | | | | | | | | | | | | | | | |
|--------|-------------------|-------------------------------|-----------------|-----------------|-----------------|-----------------|-----------------|-----------------|-----------------|-----------------|-------------------|-------------------|--------------------------|--------------------------|------------------|------------------|------------------|-----------------|
| Groups | Perimeters cm | Stela 350 steel | Stela 300 fibre | Stela 300 steel | Stela 250 fibre | Stela 250 steel | Sands 250 fibre | Sands 250 steel | Fjord 300 fibre | Fjord 300 steel | Galileo 270 fibre | Galileo 270 steel | Galileo Fusion 250 fibre | Galileo Fusion 250 steel | Fusion 300 steel | Sintra 250 fibre | Sintra 250 steel | |
| | | | | | | | | | | | | | | | | | | Stela 350 steel |
| R | 725 750 775 | 710-735 736-760 761-785 | - | - | - | - | - | - | - | - | 37 | 43 | 36 | 42 | 48 | 32 | 38 | |
| S | 800 825 | 786-810 811-835 | 56 | 41 | 43 | 35 | 40 | 30 | 40 | 41 | 51 | 40 | 46 | 40 | 46 | 51 | 36 | 42 |
| T | 850 875 | 836-860 861-885 | 62 | 43 | 49 | 38 | 46 | 37 | 45 | 46 | 56 | 45 | 53 | 45 | 52 | 56 | 40 | 47 |
| U | 900 925 | 886-910 911-935 | 64 | 44 | 51 | 40 | 48 | 38 | 46 | 48 | 58 | 47,5 | 55 | 47 | 54 | 58 | 42 | 49 |
| V | 950 975 | 936-960 961-985 | 68 | 50 | 57 | 42 | 50 | 39 | 47 | 53 | 63 | 49,5 | 58 | 48 | 56 | 63 | 43 | 51 |
| W | 1000 1025 | 986-1010 1011-1035 | 77 | 53 | 63 | 46 | 56 | 44 | 54 | 56 | 66 | 54 | 64 | 53 | 63 | 66 | 48 | 58 |
| X | 1050 1075 | 1036-1060 1061-1085 | 77 | 55 | 65 | 48 | 58 | 46 | 56 | 58 | 68 | 54 | 64 | 54 | 64 | 68 | 49 | 59 |
| Y | 1100 1125 | 1086-1110 1111-1135 | 86 | 60 | 73 | 54 | 67 | 52 | 65 | 66 | 76 | - | - | - | - | - | - | - |
| Z | 1150 1175 | 1136-1160 1161-1185 | 87 | 62 | 75 | 55 | 68 | 53 | 67 | 68 | 78 | - | - | - | - | - | - | - |
| ZZ | 1200 1225 | 1186-1210 1211-1235 | 89 | 65 | 77 | 57 | 70 | 55 | 69 | 71 | 81 | - | - | - | - | - | - | - |

| Weights (kg) | |
|-----------------|----|
| Atmosphere 350 | 22 |
| Dynamic 400 | 24 |
| Venecia 400 | 23 |
| CS-Activa 360 | 22 |
| Alpes 320 | 42 |
| Alpes 380 | 52 |
| Alpes 420 | 52 |
| Puigmal 250 | 35 |
| Mercury 360 | 31 |
| Jeroboam 360 | 31 |
| Annexes awnings | 16 |

All weights and measurements shown in this catalogue are approximate. INACA, SA reserves the right to make improvements or changes on the products.

The tones and colors of the materials embodied in this publication may vary depending on the incidence of the light and the production lot.

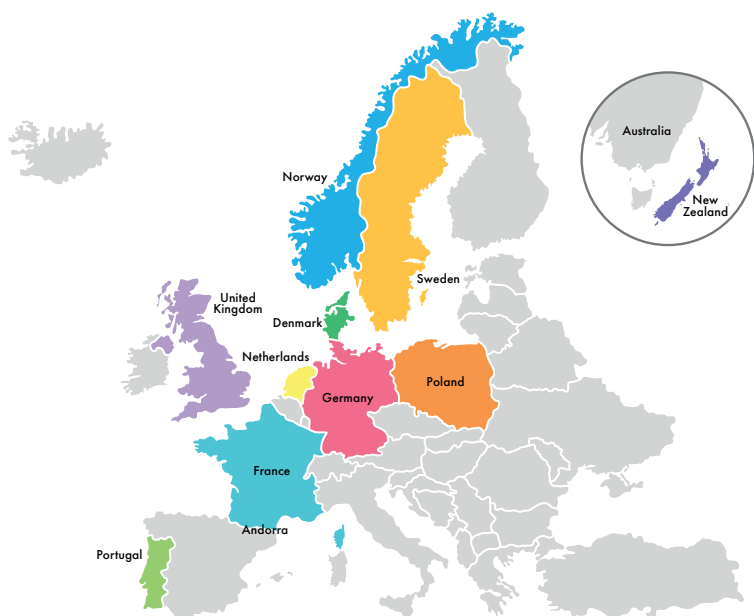

Retailers

ANDORRA

ANDORRA CAMPERS ACCESSORIS
Avda. Francesc Cairat, 9
AD600 Sant Julià de Loira
info@andorracampers.com
Tel. +37 6814440

DENMARK

STORSTRØMS CAMPING SERVICE
Nykøbingvej 58
4840 Nr. Alslev
Tel. +45 21600035
service@camping-service.dk
www.camping-service.dk

FRANCE

SOPLAIR
ZA de Fanjouge
07700 Bourg Saint Andeol
Tel. +33 475543015
soplair@wanadoo.fr
www.soplair.com

GERMANY

VORZELTE-PROFIS
Langstrasse 51-53
63450 Hanau
Tel. +49 61812573520
info@vorzelte-profis.de
www.vorzelte.profis.de

THE NETHERLANDS

MARYVO INTERNATIONAL BV
Van Leeuwenhoekweg 40
5482 TK Schijndel
Tel. +31 735472727
info@maryvo.com

NEW ZEALAND

RV&MARINE SUPPLIES LTD
15 Tasman Road, Avalon
Hamilton, 3200
Tel. +64 78467771
www.rvsupplies.co.nz
sales@rvsupplies.co.nz

NORWAY

MAX FRITID ENGROS AS
Postboks 244
N-6301 Andalsnes
Tel. +47 71220200
www.maxfritid.no

PORTUGAL

CAMPERSERV LDA
Caminho Selões, Quatro-Estradas
8100-287 Loulé (Algarve)
Tel. +35 1289093373
www.camperserv.com
info@camperserv.com

CARAVANAS COSTA AZUL LDA.

Estrada S. Luís da Serra (EN10),
2900 – 627 Setúbal
Tel. +35 1265228311
mail@caravanas-costa-azul.com
www.caravanas-costa-azul.com

Sr.GILMAR NETO SANTIAGO

Rua Principal 16 – Chipar de Baixo
3780-585 Vilarinao do Bairro
Tel. +35 1933901193
santiogil@hotmail.com

POLAND

CAMP4U
Pulawy - Warszawa
Wladyslawowo
Tel. +48 501688951
info@camp4u.eu

MCC-MOBITECH CARAVAN CENTER

Ul. Instalatorów 9 lokal 207
02-237 Warszawa
Tel. +48 228681263
info@dethleffs.pl

SWEDEN

BERGHOLM FÖRSÄJNING AB
Gesällgatan 6
681 42 Kristinehamn
Tel. +46 (0)55038080
patrik.jonsson@bergholm.com

UNITED KINGDOM

BLACK COUNTRY CARAVANS
Corgreaves Rd, Cradley Heath
West Midlands B64 7DA
Tel. 01 384413336
accessories@blackcountrycaravans.co.uk

GLOSSOP CARAVANS LTD

Main A57 Brookfield, Glossop
Derbyshire SK13 6JF
Tel. 01 457868011
pl1@glossopcaravans.co.uk

HIGHBRIDGE CARAVANS

Bristol Rd A38, Highbridge
Somerset TA9 4EX
Tel. 01 278782725
awning.sales@highbridgecaravans.co.uk

KIMBERLEY CARAVANS

Eastwood Rd, Kimberley
Nottinghamshire NG16 2HX
Tel. 01 159382401
shopfloor@kimberleycaravans.co.uk

KIMBERLEY CARAVANS

Burtree Gate, Darlington
County Durham DL2 2XZ
Tel. 01 325383333
shop.burtree@kimberleycaravans.co.uk

PRESTON CARAVANS & MOTORHOMES

Blackpool Road, Near Clifton
Preston PR4 0XL
Tel. 01 772685949
sales@prestoncm.co.uk

RENISHAW CARAVAN ACCESSORIES LTD

Bridge Street, Clay Cross
Chesterfield S45 9NU
Tel. 01 246824140 / 07734531868
mark.watts7@btinternet.com

SALOP CARAVANS

Emstrey, Shrewsbury
Shropshire SY5 6QS
Tel. 01 743282400
andy.harding@salopleisure.co.uk



awnings
2023

www.inaca.com
info@inaca.com



@inacacamping